

Technische Daten

Für Anwendungen im Fahrzeugbau (hydraulische Bremsleitungen),
Austauschbarkeit gemäß ISO 5676 und NFU 16006

Material:

Gehäuse: Stahl
Dichtung: NBR

Oberfläche:

Material: Chrom III
Beständigkeit gegen Weißrost [h]: 96
Beständigkeit gegen Rotrost [h]: 200
Temperaturbereich: -25 °C bis +125 °C

Technical data

For applications in the field of vehicle construction (brake lines),
interchangeable according to ISO 5676 and NFU 16006

Material:

Housing: Steel
Seal: NBR

Surface:

Material: Cr III
Resistance against white rust [h]: 96
Resistance against red rust [h]: 200
Temperature range: -25 °C to +125 °C

| Anschlussart Connection type | PN (bar) WP (bar) | BG | DN DN | Size Size | Zoll Inch | G G | L ₃ (mm) L ₃ (mm) | Ø D (mm) Ø D (mm) | SW (mm) SW (mm) | Artikelnummer Article number |
|---------------------------------|-------------------------------------------|----|----------------------------------------|--------------|--------------|---------|--------------------------------------------|----------------------|--------------------|---------------------------------|
| | BSP Innengewinde DIN 3852 | | BSP female DIN 3852 | | | | | | | |
| | 150 | 3 | 12 | 08 | 1/2 | 3/8 | 56,0 | 44,0 | 27 | VC-BC1G3/8BSP12M |
| | 150 | 3 | 12 | 08 | 1/2 | 1/2 | 56,0 | 44,0 | 27 | VC-BC1G1/2BSP12M |
| | Metrisches Innengewinde ISO 8434-1 | | Metric female thread ISO 8434-1 | | | | | | | |
| | 150 | 3 | 12 | 08 | 1/2 | M18x1,5 | 56,0 | 44,0 | 27 | VC-BC1G18M12M |

Zubehör

Staubschutz Stahl: Für Steckkupplung Serie VC-BC Muffe

Accessories

Dust protection steel: For plug-in coupling series VC-BC (sleeve)

| | BG | DN DN | Size Size | Zoll Inch | Material Material | Artikelnummer Article number |
|--|----|----------|--------------|--------------|----------------------|---------------------------------|
| | 3 | 12 | 08 | 1/2 | Stahl steel | VC-BC-DP-ST-M |

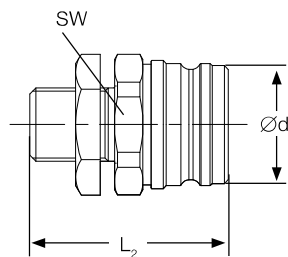

Technische Daten

Für Anwendungen im Fahrzeugbau (hydraulische Bremsleitungen),
Austauschbarkeit gemäß ISO 5676 und NFU 16006

Material:

Gehäuse: Stahl
Dichtung: NBR

Oberfläche:

Material: Chrom III
Beständigkeit gegen Weißrost [h]: 96
Beständigkeit gegen Rotrost [h]: 200
Temperaturbereich: -25 °C bis +125 °C

Technical data

For applications in the field of vehicle construction (brake lines),
interchangeable according to ISO 5676 and NFU 16006

Material:

Housing: Steel
Seal: NBR

Surface:

Material: Cr III
Resistance against white rust [h]: 96
Resistance against red rust [h]: 200
Temperature range: -25 °C to +125 °C

| Anschlussart Connection type | PN (bar) WP (bar) | BG | DN DN | Size Size | Zoll Inch | G G | L ₂ (mm) L ₂ (mm) | Ø d (mm) Ø d (mm) | SW (mm) SW (mm) | Artikelnummer Article number |
|---------------------------------|------------------------------------------------------------------------------------------------------|----|----------|--------------|--------------|---------|--------------------------------------------|----------------------|--------------------|---------------------------------|
| | BSP Außengewinde DIN 3852 BSP male-thread DIN 3852 | | | | | | | | | |
| | 150 | 3 | 12 | 08 | 1/2 | 1/2 | 48,0 | 30,0 | 32 | VC-BC-AG1/2BSP12S |
| | CE Schott-Außengewinde leichte Reihe, DIN 3861 Male thread CE-bulkhead light series, DIN 3861 | | | | | | | | | |
| | 150 | 3 | 12 | 08 | 1/2 | M16x1,5 | 52,0 | 30,0 | 32 | VC-BC16-20CELS10-12S |
| | 150 | 3 | 12 | 08 | 1/2 | M18x1,5 | 52,0 | 30,0 | 32 | VC-BC18-20CELS12-12S |
| | 150 | 3 | 12 | 08 | 1/2 | M18x1,5 | 51,0 | 30,0 | 32 | VC-BC-CELS12-12S |
| | 150 | 3 | 12 | 08 | 1/2 | M22x1,5 | 51,0 | 30,0 | 32 | VC-BC-CELS15-12S |
| | CE Schott-Außengewinde schwere Reihe, DIN 3861 CE bulkhead-male thread heavy series, DIN 3861 | | | | | | | | | |
| | 150 | 3 | 12 | 08 | 1/2 | M18x1,5 | 51,0 | 30,0 | 32 | VC-BC-CESS12-12S |

Zubehör

Staubschutz: Für Steckkupplung Serie VC-BC Stecker

| | BG | DN DN | Size Size | Zoll Inch | Farbe Color | Material Material | Artikelnummer Article number |
|--|----|----------|--------------|--------------|----------------|----------------------|---------------------------------|
| | 3 | 12 | 08 | 1/2 | grau grey | Kunststoff plastic | VC-BC-DP-PL-S |

Accessories

Dust protection: For plug-in coupling series VC-BC (plug)